

Tree Protection Barriers

- Tree protection barriers must be constructed with a solid wood frame clad with plywood or approved equivalent. Height of hoarding may be less than 8 ft. to accommodate any branches that may be lower.
- Tree protection barriers for trees situated on the City road allowance where visibility must be maintained can be 1.2m (4ft.) high and consist of orange plastic web snow fencing on a wood frame made of 2 x 4s.
- Where some excavate or fill has to be temporarily located near a tree protection barrier, plywood must be used to ensure no material enters the Tree Protection Zone.
- No construction activity, grade changes, surface treatment or excavations of any kind is permitted within the Tree Protection Zone.

Note:
Sediment control fencing shall be installed in locations indicated in an Urban Forestry approved Tree Protection Plan. The sediment control fencing must be installed to Ontario Provincial Standards (OPSD-219.130) heavy duty silt fence barrier and to the satisfaction of Urban Forestry. See Detail TP-2



Parks, Forestry and Recreation

February 2016

Detail TP-1

Tree #	Common Name	Latin	dbh (cm) @ 1.4 m	Height (m)	Crown Spread (m)	MTPZ (m)	Ownership	Health	Structure	Overall Condition	Application to Injure Fees	Address	Location	Comments	Arborist Specification
1	Norway Maple	Acer platanoides	65	16	12	4.2	City	Good	Good	Good	\$0.00	75 Regal Rd.	3 metres south of curb 3.5 metres east of west property line		Tree protection fencing
2	White Mulberry	Morus alba	36	14	9	2.4	Private	Good	Fair	Good	\$0.00	75 Regal Rd.	11.3 metres south of south building line 0.5 metres east of west property line	2 stems; 25, 36 cm dbh Poor location	Tree protection fencing
3	White Mulberry	Morus alba	45	15	9	3	Private	Good	Good	Good	\$0.00	1366/1368 Davenport Rd.	2.1 metres south of north property line 8.2 metres west of east property line of 75 Regal Rd.	Poor location, damaging fence	Tree protection fencing
4	White Poplar	Populus alba	121	28	16	7.26	Private	Good	Good	Good	\$0.00	73 Regal Rd.	12 metres south of south building line of 75 Regal Rd. 8.0 metres east of east property line of 75 Regal Rd.	Has been maintained well	
5	Callery Pear	Pyrus calleryana	40	15	5	2.4	Private	Good	Poor	Fair	\$0.00	77 Regal Rd.	3.4 metres south of south building line of 75 Regal Rd. 1 metre west of east property line		Tree protection fencing
6	Callery Pear	Pyrus calleryana	34	15	5	2.4	Private	Good	Poor	Fair	\$0.00	77 Regal Rd.	0.9 metres north of south building line of 75 Regal Rd. 1 metre west of east property line		Tree protection fencing

RECEIVED

By Committee of Adjustment at 9:53 am, Nov 19, 2021

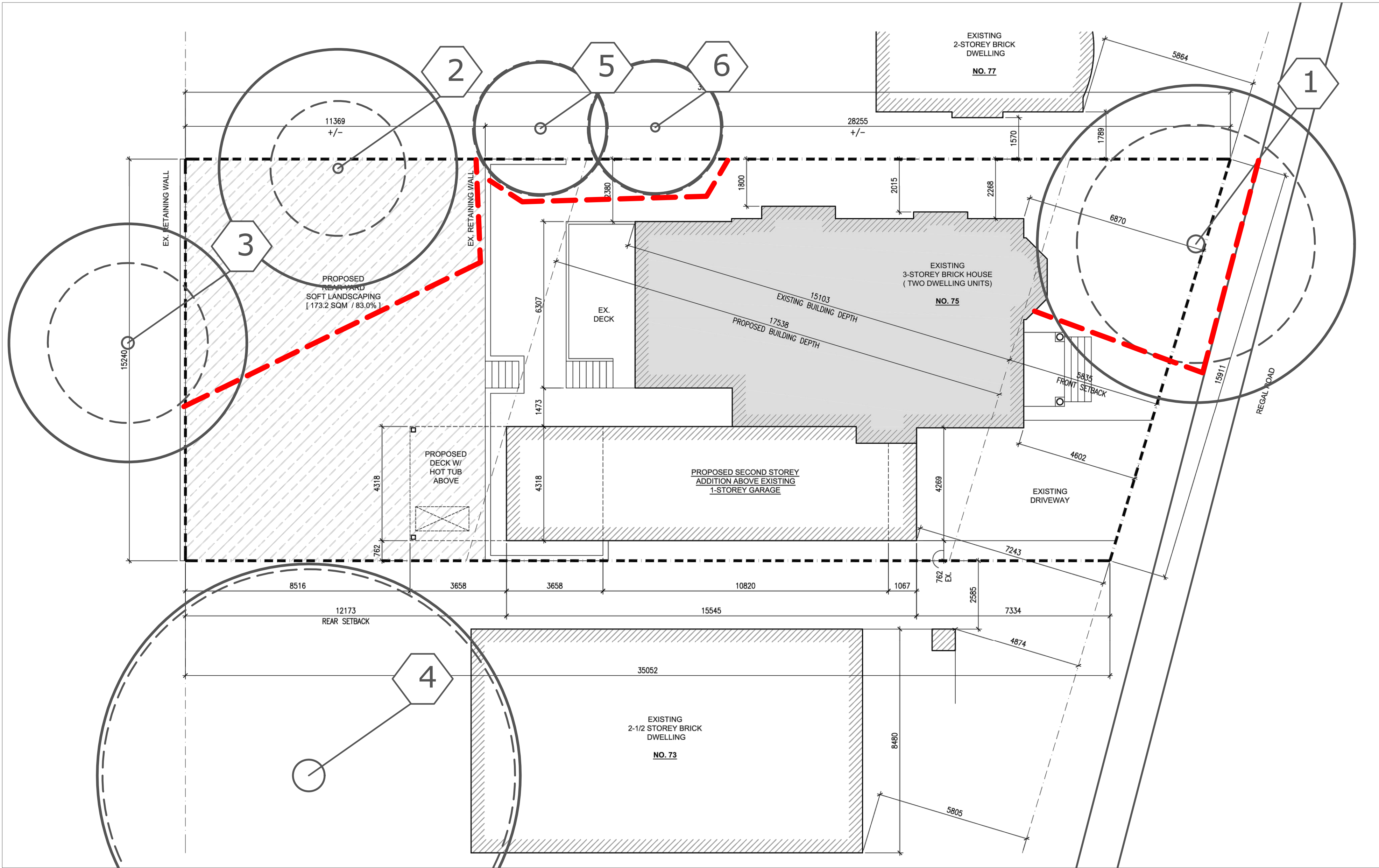

Project:
75 Regal Rd, Toronto

Tree Preservation Plan

Client:

George Papik
75 Regal Rd.
Toronto ON M6H 2J6
647-967-5296
andrew.papik@gmail.com

Notes:

1. All field data collected by Mark Ellis, ISA BCMA ON-1686BM on November 8, 2021

Legend:

Identification Number

2

Toronto Minimum Tree Protection Zone (MTPZ)

Approx Crown Spread

Tree Protection Fencing - Rigid Hoarding

Horizontal Hoarding

Existing Tree to Remain and be Protected

Existing Tree to be Removed to Facilitate Construction

Existing Tree to be Removed (Unrelated to Construction)

Tree to be Planted

No.	DATE	BY	REVISIONS

APPROVALS

MUNICIPAL

DIRECTOR OF ENGINEERING

DATE

STAMP

DRAWING NO.

TP - 1

CONTRACT NO.

SCALE

1:100

SHEET

1 OF 1